

China Custom Design high speed Toothpaste cartoning machine Manufacturers



Product Detail







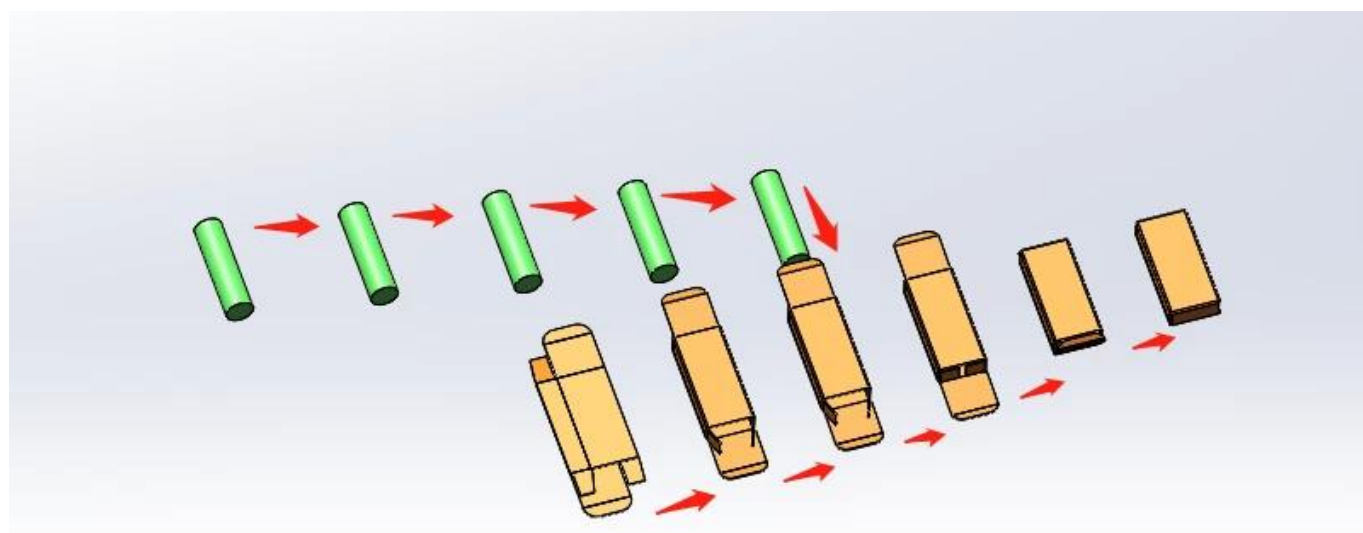
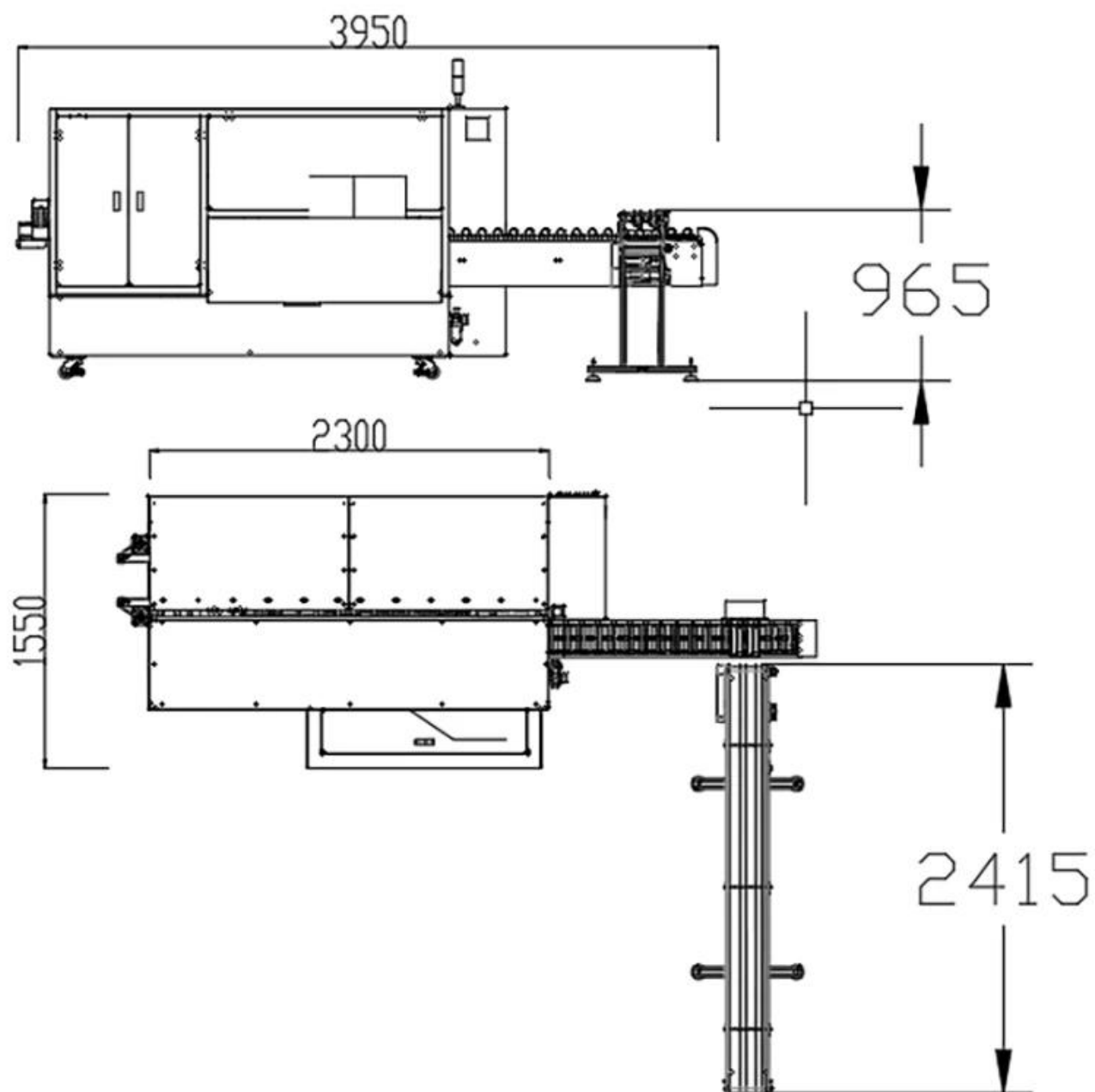

Product Sample



Product Advantages

This equipment integrates light, gas, and electricity, and adopts a PLC operating system. It is suitable for packaging products with a large output such as daily chemical products and pharmaceuticals.

The equipment uses continuous box opening and pushing methods for box opening and pushing, and the production speed can reach between 100-150 boxes per minute. It has the characteristics of stable packaging and high output. Can better save manpower!

Product Specification

Model:	JYT-GS150
carton size range:	L 110-200 * W 30-70 * H 18-45mm (can be customized according to product)
Paper Requirements Scope:	300 g/m ² ≤ Best for paper: 350 g/m ² ≤ 450 g/m ²
Paper requirements:	The indentation of the paper box is not less than 0.4mm, with a pre folding effect
Production capacity:	100-150box/min
Total power:	3 KW
Equipment dimensions:	About L3950 * W1550 * H1730mm
Machine weight:	About 2T

Payment

You can pay by 100% T/T, Ali-pay, 70% L/C at sight would be available for qualified bank.



About us



Foshan Jiayite Packaging Machinery Co., Ltd. is a professional and reliable manufacturer of bottle filling machine, capping machine, labeling machine and pouch packing machine . We are providing quality packing solutions for bottle filling and packing in the industries of home care and personal care , foodstuff, agrochemical , chemical and lubricate oil for liquids, cream/oointment, fluid and half-fluid, powders, and granules products.

With years experience and development, We have Obtained ISO9001 quality management system authentication and parts of our products have passed CE authentication.

EXHIBITION RECORD

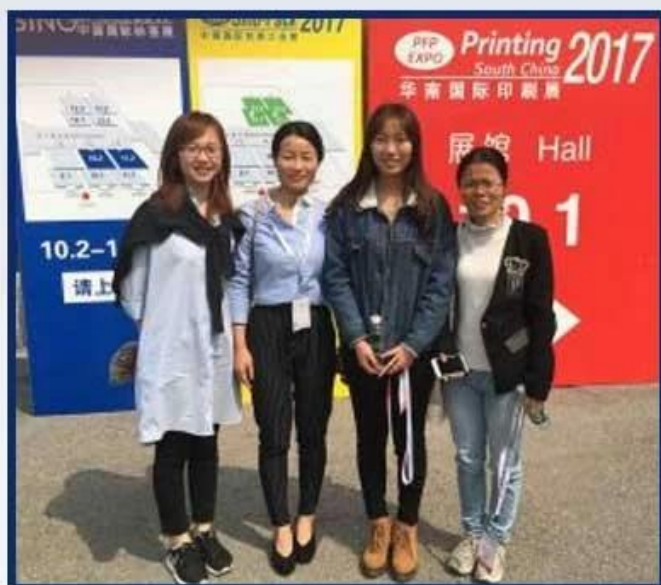

Our Customers •



Our Advantage •

On-site installation,
commissioning and training

Specially customized
based on actual situation



High automation, simple
operation and labor saving

Life long technical
service support

AFTER-SALES SERVICE



PACKAGING SHIPPING



It can be shipped by terms of Ex-work, FCA,FOB,CNF,CIF by sea or by air
DHL, UPS, FedEx, TNT, EMS etc□based on the buyer's forwarder or ours.

FAQ

Q1.Are you a manufacturer?

A1:Yes, we are an experienced manufacturer with our own brand and production lines.

Q2.How about quality of products?

A2: Our technicians and QC teams test the products one by one using aging line, professional devices and instruments to ensure the quality for all products.

Q3.How about price?

A3: We are a manufacturer and always offer our customers the most competitive prices.

Q4.How to place an order?

A4: Contact with online service, or sent email to us directly, we will reply to you with product price, specifications, packing etc. soon. Thank you.

Q5.May I send samples to you testing?

A5: Yes! You are welcome to send us your products to test by our machine.

Q6.Can I visit your factory?

A6: Yes, welcome to visit our factory at your convenient time.